



# Welcome to Colors of Motion

Welcome and thank you for choosing to participate in the Northstars Varsity Winterguard Colors in Motion Competition being held on February 12, 2022. Here is some important information we would like to share with you.

<b>Event Date:</b>	Saturday, February 12, 2022
<b>Gym Doors Open:</b>	2:15 PM
<b>Event Time:</b>	3:00 PM for first show and 5:40 for second show.
<b>Concessions:</b>	Open at 2 PM – Due to Covid the menu will be limited to prepackaged food, snacks and drinks.
<b>Ticket Prices:</b>	Both shows \$8.00, Seniors: \$5.00, 5 and under free, One show \$5.00, Seniors: \$3.00, 5 and under free.
<b>Spectators:</b>	<b><u>MUST</u></b> sit 3 feet apart unless from the same family. <b><u>Masking is REQUIRED at all times.</u></b>
<b>Program:</b>	\$3.00

**Mask and Social Spacing: Masks are required at all times in school buildings.**

**Check in:** A Host will meet each participating guard upon arrival/check in. Please have your Crew Sign-in sheet with you. You will receive your room assignment and be escorted to your room at that time. Guard members, chaperones, instructors, and those on the crew sign-in sheet will be given a wrist band and allowed in the homeroom area. An adult representative of your group must sign the Homeroom Agreement. Spectators will not be allowed in the homerooms. Please leave your room the way that you found it and please review this detail with your parents and staff so we don't encounter any issues.

## **Covid Protocol Updates:**

- If another guard is unloading when you arrive, please wait until they have entered the building and completed their check in before you enter.
- Guards will be assigned a classroom at the show. We will be making every effort to keep teams spread out as much as possible.
- PLEASE be aware when stretching the hallway that you need to social distance. We ask that teams leave after their portion of the show (first half/second half).
- Spectators will be allowed in the gymnasium but must mask and social distance. Teams may sit in the back for their portion of the show only.
- We will hold 2 retreats/Awards. Units are expected to leave after the first half, unless other arrangement have been made. We also understand some units may need to leave after they perform. Please make sure we are aware for awards/retreat. An online live video will be posted to the MYCGC facebook page for units that leave.
- **Admission for Unit Members and Personnel:** units will receive wristbands upon arrival for each Unit Member, Staff, Chaperone and Crew.
- Post contest meeting will be in the LGI (see map at end). Instructors are requested to wait in the body warm-up cafeteria due to covid. Please social distance.

**Equipment Trucks and Buses:** Guards should be dropped off at the doors by the Main Entrance of the circle at the circle in front. Props and equipment should follow outdoor signs to their drop-off location behind the school. No

props will be checked in before 1:30 PM.

**Gender Neutral Restrooms and Changing:** There will be a gender neutral lavatory available near the guard entry area of the school.

**Sound:** Sound check will be 1 hour pre show & during break between the 1st and 2nd show, sound by Great Music Company. Please have all show music labeled with your guard name. Please pick up your music after your guard performs.

**Video:** Due to copyright restrictions the MYCGC can not allow videotaping.

**Warm Up/ Performance Times:** Please see the attached Schedule for your assigned warm up area, times, and the performance time that was determined by Mid York CGC. **Due to Covid there will NOT be a guide to pick up teams. Directors are responsible for their own teams to be on time.**

**Floor mat/prop/ floor Snaking:** Per MYCGC directive, all guard units are to “snake” their floors out of the gym following their performance. See maps for guard/prop entry doors and the flow.

**Gym notes:** **There are speakers hanging over the basketball court, guards should be aware of. They are in line with the basketball hoops. Please make your guard and instructor aware. The backboards do NOT go up.**

**In case of emergency:** Announcements regarding the exits will be made throughout the show and emergency exits backstage will be marked and free from obstructions.

**Awards/Retreat:** A standard retreat/awards will be held following the conclusion of each half. Captains are requested to assemble in the equipment warm-up gym, in performance order, at the beginning of the final performance of each half.

**Judges' Commentary and Recap:** Class recaps will be available before critique. Judges commentary will be available through Competition Suite.

**Critique:** Critique will take place immediately following the final guard's performance after the second show. Per MYCGC, critique order will be in **performance order**. If you wish to go in an earlier round you must submit a written request to the show host before show day.

**Smoking:** **There is No Smoking Permitted on school grounds. Please remind your parents, chaperones and floor crew of this important rule.**

### Directions :

**From the North** ~ Take Route 81 South, exit 28 Taft Road. Turn right onto Taft Rd/ School will be on your right approx 1 mile. You will go thru 3 lights, school is at the fourth light.

**From the South** ~ Take Route 81 North, exit 28 Taft Road. Turn left onto Taft Rd. School will be on your right approx. 1 mile. You will go thru 3 lights, school is at the fourth light.

**From the West** ~(Rochester) **Or East** (Albany) Take NYS Thruway to exit 36, straight after toll booths to Route 81 North. Take exit 28 Taft Road. Turn left onto Taft Rd. School will be on your right approx 1 mile. You will go thru 3 lights, school is at the fourth light.

**If using a GPS the address is:**

**North Syracuse Junior High School**

**5353 W. Taft Road**

**North Syracuse, NY 13212**

If you need to contact us the day of the show, we can be reached at the following numbers.

Larry Schmidt (315) 402-7318

[larschmidt@yahoo.com](mailto:larschmidt@yahoo.com)

Jessica Hoffman (315) 200-4760

[empatry.jh@gmail.com](mailto:empatry.jh@gmail.com)

Good Luck to All and Enjoy the Show!

Sincerely;

Larry Schmidt

Northstars Varsity Winterguard Director

Jessica Hoffman

Home Show Coordinator

# The CNS Winter Guard

## Colors in Motion/Music Winterguard Show

### Homeroom Agreement

Date: \_\_\_\_\_

Guard Name: \_\_\_\_\_

Name: \_\_\_\_\_

(please print)

As the representative for the above named unit, I agree to return the homeroom to which we have been assigned to the condition in which it was found. Further, I understand that any electronic devices that may be in the room (i.e. computer, TV) are not to be used.

I also understand that the unit's Director and/or the Director's organization will be held responsible for any damages or missing items.

Do not open or go through the teacher's desk or any closed files.

Homeroom Assigned: \_\_\_\_\_

Signature: \_\_\_\_\_

Title: \_\_\_\_\_

# FLOOR CREW / STAFF / CHAPERONE SIGN IN SHEET

GUARD \_\_\_\_\_ Class \_\_\_\_\_

1. \_\_\_\_\_

2. \_\_\_\_\_

3. \_\_\_\_\_

4. \_\_\_\_\_

5. \_\_\_\_\_

6. \_\_\_\_\_

7. \_\_\_\_\_

8. \_\_\_\_\_

9. \_\_\_\_\_

10. \_\_\_\_\_

11. \_\_\_\_\_

12. \_\_\_\_\_

13. \_\_\_\_\_

14. \_\_\_\_\_

15. \_\_\_\_\_

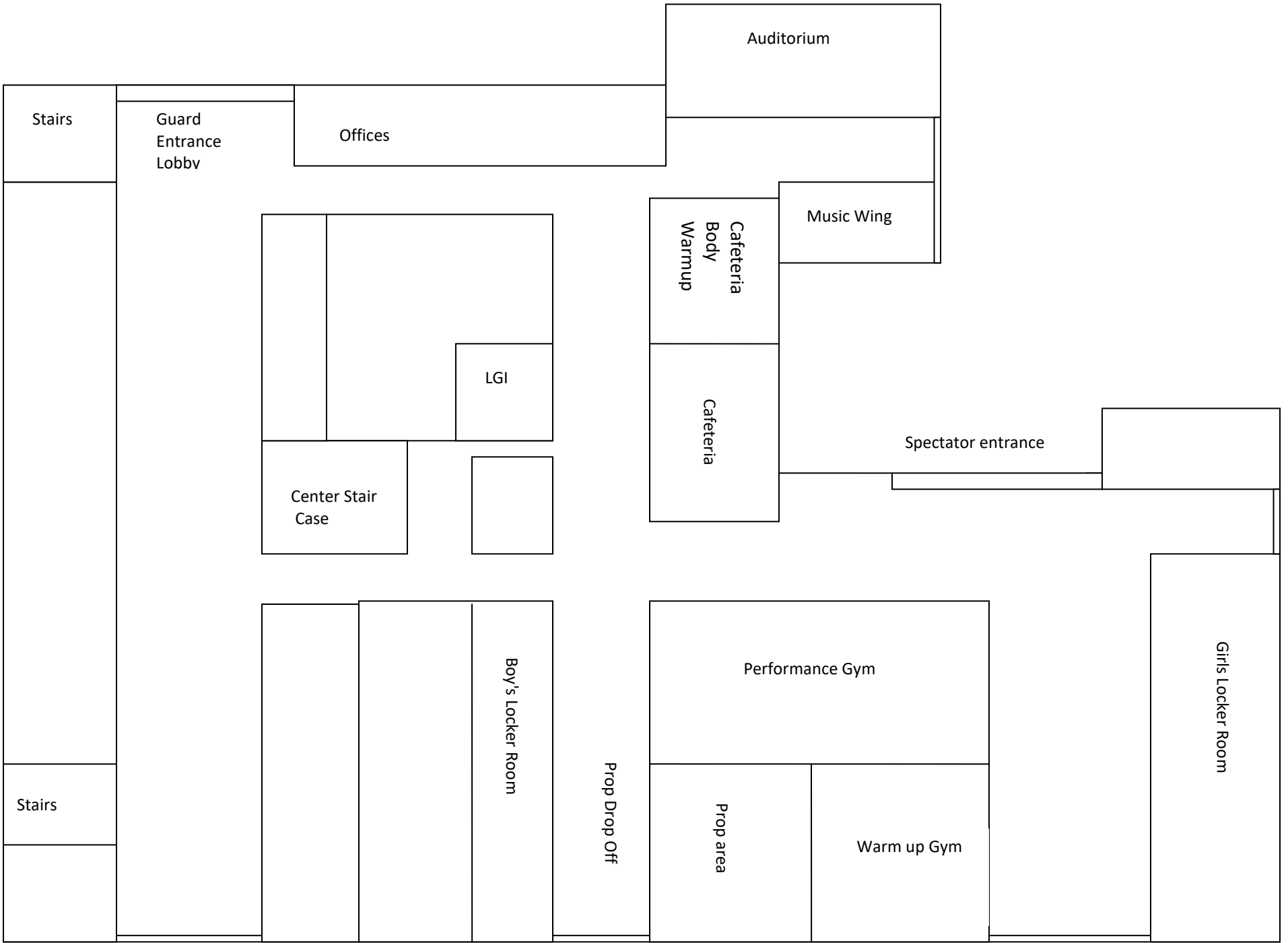

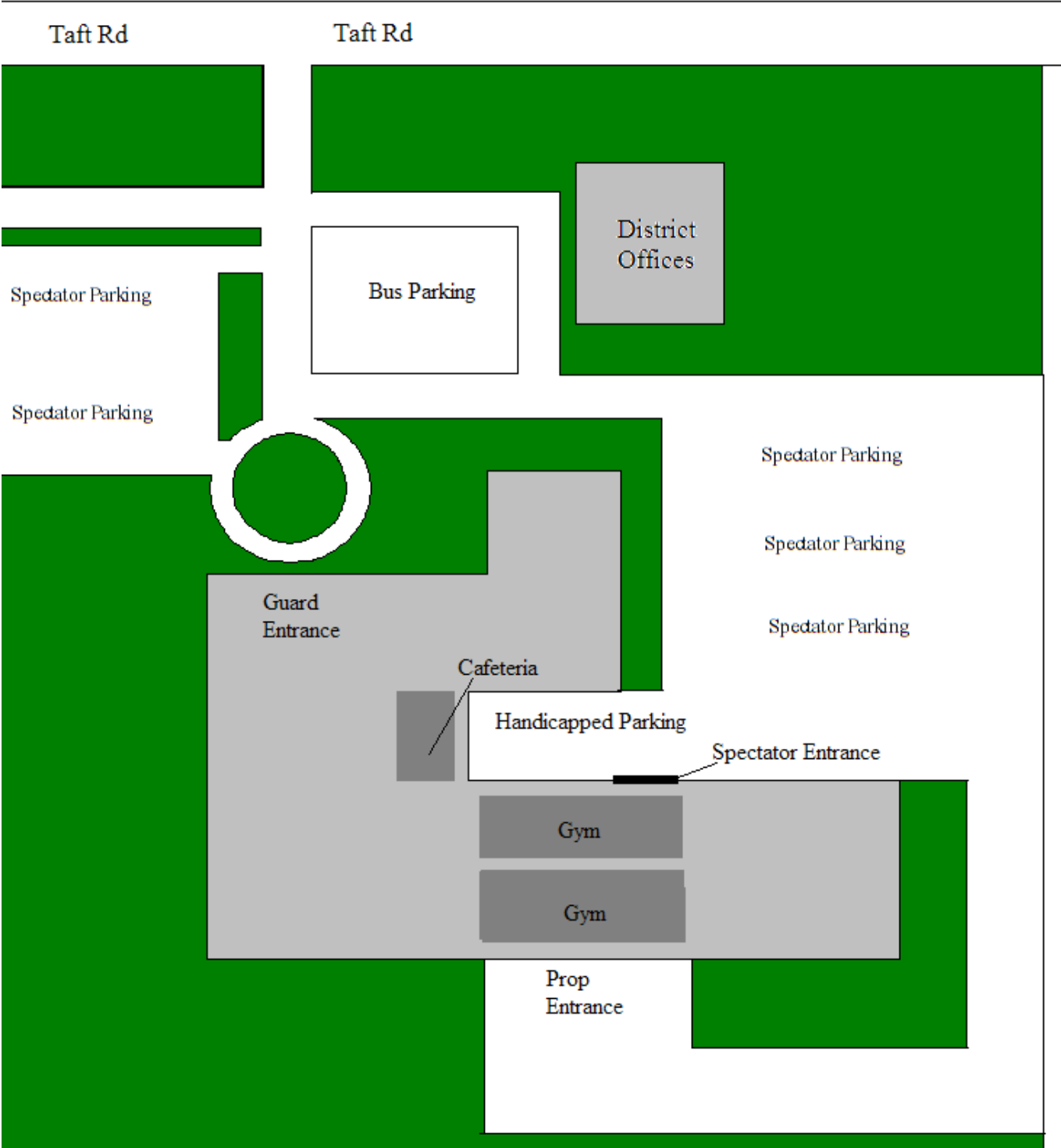

### BASKETBALL COURT NOTES

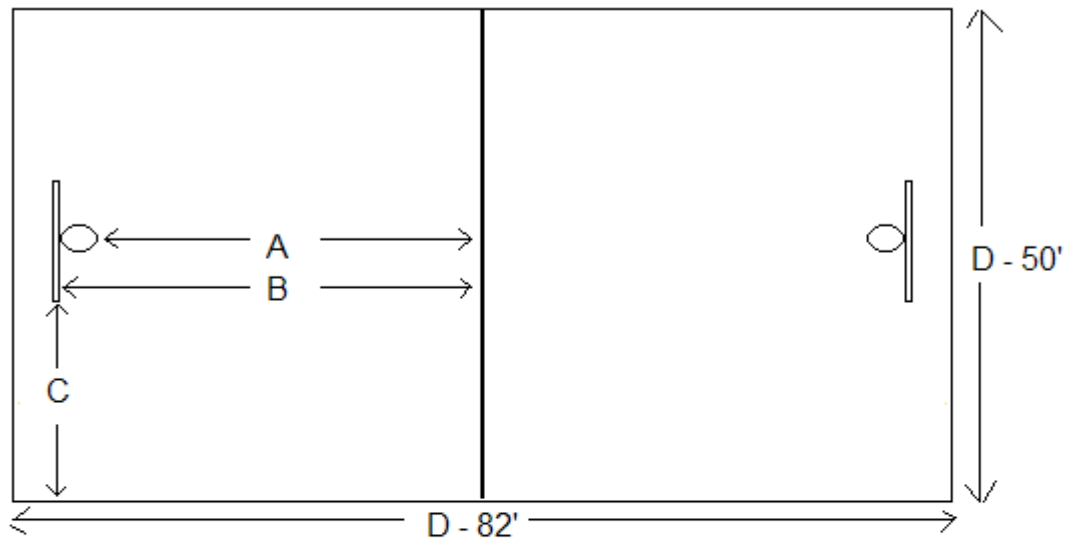

A - from the center of center to the front of the rim - 35' 6" (times 2 = 71')

B - from the center of center to the backboard - 37' 6" (times 2 = 75')

C - from the front sideline to the edge of the backboard - 22' 6"

D - Boundaries of basketball court - 82' across x 50' deep.



## Schedule CNS Varsity Show - February 12, 2022

Guard	Class	Ready	Body Warm-up start	Body Warm-up end	EQ Warm-up start	EQ Warm-up end	Perform Start	Perform End
Announcements/Nat Anthem		2:50	2:50	2:55	2:55	3:00	3:00	3:05
Laurens Jaguars ERA	ERA	2:35	2:41	2:48	2:53	3:00	3:05	3:12
Laurens Junior Jaguars	Cadet	2:42	2:48	2:55	3:00	3:07	3:12	3:19
Vestal Cadet	Cadet	2:49	2:55	3:02	3:07	3:14	3:19	3:26
CNS Northstars Jr	Cadet	2:56	3:02	3:09	3:14	3:21	3:26	3:33
Albany City Cadet	Cadet	3:03	3:09	3:16	3:21	3:28	3:33	3:40
Liverpool JV	Cadet	3:10	3:16	3:23	3:28	3:35	3:40	3:47
Judge break							3:47	3:52
Horseheads Winter Guard	SRA	3:22	3:28	3:35	3:40	3:47	3:52	3:59
Vestal Senior Winterguard	SRA	3:29	3:35	3:42	3:47	3:54	3:59	4:06
ESM JV	SRA	3:36	3:42	3:49	3:54	4:01	4:06	4:13
CentralSquare JV	SRA	3:43	3:49	3:56	4:01	4:08	4:13	4:20
Oswego Winterguard	SRA	3:50	3:56	4:03	4:08	4:15	4:20	4:27
Baldwinsville JV	SRA	3:57	4:03	4:10	4:15	4:22	4:27	4:34
New Hartford JV	IRA	4:04	4:10	4:17	4:22	4:29	4:34	4:41
<b>Awards #1</b>							4:41	5:01
Intermission 2							5:01	5:41
Dare Winterguard	IAA	5:11	5:17	5:24	5:29	5:36	5:41	5:48
ALBANY CITY IAA	IAA	5:18	5:24	5:31	5:36	5:43	5:48	5:55
Corning-Painted Post	SA3	5:26	5:31	5:39	5:43	5:51	5:55	6:03
CNS Northstars JV	SA3	5:34	5:39	5:47	5:51	5:59	6:03	6:11
West Genesee Winterguard	SA3	5:42	5:47	5:55	5:59	6:07	6:11	6:19
Baldwinsville Varsity	SA2	5:50	5:55	6:03	6:07	6:15	6:19	6:27
Laurens Jaguars	SA2	5:58	6:03	6:11	6:15	6:23	6:27	6:35
Introspection Independent	IA	6:06	6:11	6:19	6:23	6:31	6:35	6:43
Judge break							6:43	6:48
Liverpool Varsity	SA1	6:19	6:24	6:32	6:36	6:44	6:48	6:56
New Hartford Varsity	SA1	6:27	6:32	6:40	6:44	6:52	6:56	7:04
ESM Varsity	SA1	6:35	6:40	6:48	6:52	7:00	7:04	7:12
Central Square Varsity	SO	6:44	6:48	6:57	7:00	7:09	7:12	7:21
CNS Northstars Varsity	SO	6:53	6:57	7:06	7:09	7:18	7:21	7:30
<b>Awards #2</b>							7:30	8:00

Revised 1/19/2022